

TITLE: ENGINEERING CONTROL DRAWING

PART IDENTIFIER: 5307

DESCRIPTION: HIGH POWER LOAD, BERYLLIA

ASSEMBLY DWG: 1700044

1.0 SPECIFICATIONS:

1.1 ELECTRICAL:

- 1.1.1 RESISTANCE VALUE: 50Ω NOMINAL.
- 1.1.2 INPUT POWER: (@ 100°C HEAT SINK, DERATED LINEARLY TO ZERO POWER AT 150°C):
 - 1.1.2.1 AVERAGE: 150 WATTS.
 - 1.1.2.2 PEAK: 1250 WATTS (BASED ON 100US PULSE WIDTH AND 1% DUTY CYCLE).
- 1.1.3 FREQUENCY RANGE: DC - 2.0 GHZ.
- 1.1.4 VSWR: DC - 1.0 GHZ, 1.10 MAX.
1.0 - 2.0 GHZ, 1.25 MAX.

1.2 MECHANICAL:

- 1.2.1 OUTLINE DWG: SEE SHEET 2.
- 1.2.2 WORKMANSHIP: PER MIL-STD-454, REQUIREMENT 9, AND MIL-R-55342.

1.3 ENVIRONMENTAL:

- 1.3.1 TEMPERATURE RANGE:
 - 1.3.1.1 STORAGE: -65°C TO +150°C.
 - 1.3.2.1 OPERATING: -55°C TO +150°C.

2.0 UNIT MARKING: "EMCT" AND PART IDENTIFIER.
LEGIBILITY AND PERMANENCY PER MIL-STD-130.

3.0 QUALITY ASSURANCE:

- 3.1 VISUAL AND MECHANICAL PER IP-1036.
- 3.2 100% DC RESISTANCE CHECK (GO/NO GO): 50Ω ± 7%.
- 3.3 DATA REQUIREMENTS:
 - 3.3.1 NO TEST DATA REQUIRED FOR CUSTOMER.
 - 3.3.2 DATA RETENTION - STANDARD.

4.0 PACKAGING: STANDARD PACKING PER MC0023.

ENG	PUR	MFG	PLAN	SM	
CC		QA			
EMC TECHNOLOGY, INC 1971 OLD CUTHBERT ROAD CHERRY HILL, NJ 08034	CAGE CODE # 24602			DWG #	1001025000
	CHANGE NOTICE	EN 00-582		REV LVL	K
				SHEET	1 OF 2

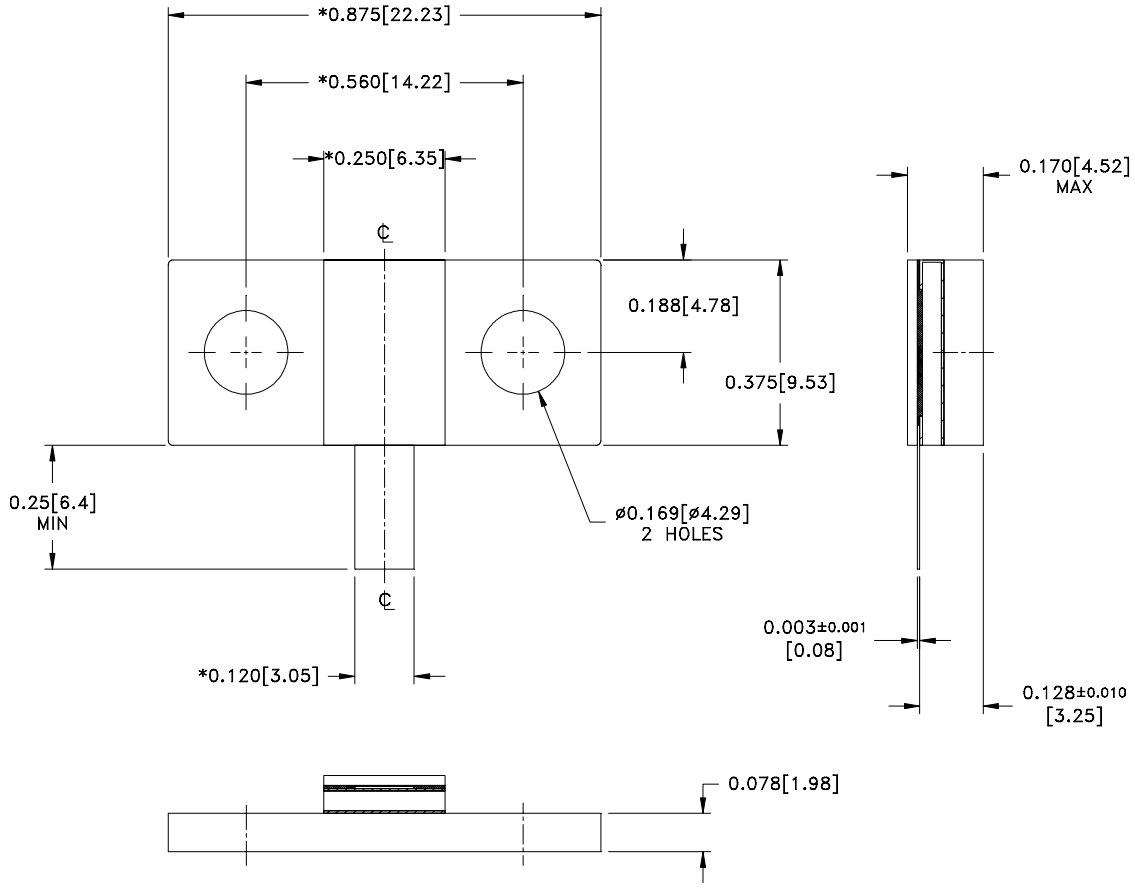

MECHANICAL SPECIFICATIONS:

- CHIP:
MATERIAL - BERYLLIA, ASTM F356.
- TOP PLATE:
MATERIAL - ALUMINA, MIL-I-10.
- TAB:
MATERIAL - COPPER, ASTM B152.
FINISH - SILVER, QQ-S-365.
- HEAT SINK:
MATERIAL - COPPER, ASTM B187.
FINISH - NICKEL, QQ-N-290.



METRIC EQUIVALENTS GIVEN IN [mm]
ARE FOR REFERENCE INFORMATION ONLY

ALLOW +/-0.010 ON TOP PLATE FOR MISALIGNMENT.
* DIMENSIONS TO BE SYMMETRICAL ABOUT C.L. WITHIN +/-0.005 .

<p>EMC TECHNOLOGY INC 1971 OLD CUTHBERT RD CHERRY HILL NJ 08034 PHONE NO. (856) 429-7800 FAX NO. (856) 429-1807</p>	<p>UNLESS OTHERWISE SPECIFIED DIMENSIONS ARE IN INCHES TOLERANCES</p> <p>FRACT --- ANG --- XX --- XXX ±0.005 XXXX ---</p>	<p>THESE DRAWINGS AND SPECIFICATIONS ARE THE PROPERTY OF EMC TECHNOLOGY INC AND SHALL NOT BE DUPLICATED OR USED AS BASIS FOR THE MANUFACTURE OR SALE OF PARTS OR DEVICES WITHOUT PERMISSION.</p>					
		CAGE CODE	SCALE	DRAWN BY	CHECKED BY	APPROVED BY	
		24602	1:1	BEC 12-7-00		FJV 12-15-00	
		REV	CHANGE NOTICE	DRAWING NO	SHEET		
K	EN 00-582	1001025000	2 OF 2				